

The Country Cabin



2

Cosy Country Living



1

The Country cabin is a fully self contained cabin, perfect for singles, couples, children or retirees.

The compact and self contained cabin meets shire requirements for ancillary accommodation, utilising approximately 60 square metres.

**External
kit from:**
\$38,314

**Internal
kit from:**
\$25,586

Kit Homes are ideal for urban or rural areas offering attractive design, coupled with functional architecture. A Kit Home can be designed and erected in a matter of weeks with modern features and additions such as home gyms, theatre rooms, spas and gourmet kitchens.

Kit homes are created with owner building in mind and offer an affordable housing solution to suit you and your family. Kit homes offer pre-fabricated components typically ideal for residential housing, which are more cost effective, as well as quicker to build.

108 Windsor Road, Wangara WA 6065

Phone: (08) 9409 2733

E: info@westkey.com.au | W: www.westkey.com.au

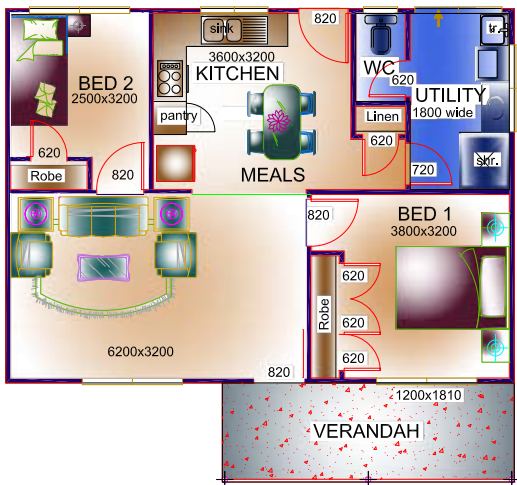

Features:

- ◆ Combined Utility
- ◆ Separate WC
- ◆ Kitchen / meals
- ◆ Living
- ◆ Verandah
- ◆ Can be supplied to suit cyclonic conditions (POA)
- ◆ Designed for 2.7m ceiling height
- ◆ Total area covered: 80.12m²

Eco Rating:

Supplied to comply with current BCA Energy Efficiency requirements.

Specifications:

1. Designed and fully engineered for your site and built on a concrete pad or elevated floor system. (Elevated floor system extra to shown external kit picture)
2. Hi Tensile 89mm steel wall and roof framing.
3. Choice of external wall claddings: Colorbond, traditional weatherboard or modern fibre cement boards.
4. Colorbond roof sheeting with selected insulation to achieve the required minimum 5-star energy efficiency ratings

Choose one of our designs or have Westkey Modular Housing's qualified and experienced designers turn your ideas into your dream home in a matter of weeks!



108 Windsor Road, Wangara WA 6065

Phone: (08) 9409 2733

E: info@westkey.com.au | W: www.westkey.com.au